

Compact Wedgmount® Precision Levelers Type 500-QFixx

Features and benefits

- Compact precision leveler for maximum design flexibility
- Bolt-on and bolt-through versions available to fit all attachment requirements
- Available as socket version for inaccessible machine feet (mineral cast machine bed)
- Centered bolt-on thread or bolt-through hole provides ideal loading for longer life
- Fast and precise leveling mechanism, for easy, safe installation
- Low leveling torque required up to maximum load capacity for easy height adjustment
- Enclosed adjustable mechanism for long term reliability
- Ruggedly designed spherical seat for uneven floors or rough machine feet
- Offers highly efficient vibration isolation performance in combination with our well-known AirLoc Isolation Pads

Modern machine design becomes more efficient with every new machine generation. Area of machine support is reduced on these new models. Therefore, the design requirements of the machine support increases daily. Typical mounting systems cannot fulfill all of these requirements.

Due to the reduction of supports in modern machine design, we have to deal with increased load requirements as well as high reliability of our leveling mounts.

AirLoc has responded to these challenges by providing the new Compact Wedgmount® Precision Leveler, type 500-QFixx. Availability of different versions provide maximum design flexibility for a highly efficient and economic machine support design. When combined with our AirLoc Isolation Pads, the result is reduced dynamic loads on the machine structure along with providing vibration isolation performance.

Fast and precise leveling based on low adjustment torque makes machine installation easy and reliable. The centrally mounted attachment bolt ensures that the unit will remain securely clamped even when the machine is lifted off the floor for relocation. These features make the new Compact Wedgmount® Precision Leveler, type 500-QFixx an ideal tool for safe, easy and reliable machine installation and reinstallation.

Ideally suited for the following applications:

- Milling- and Grinding machines
- Lathes
- Boring mills
- Injection molding machines
- Graphic machines
- Transfer lines
- Textile industrial machines

Ask for our new
AirLoc catalogue
free of charge!

Color
Jet black RAL 9005

- Compact Wedgmount® Precision Levelers where space is limited to install machine mounts
- Bolt-on and bolt-through versions are available as standard configurations
- 515-QFixx also available for subsequent anchoring version (KaBloc)
- Enclosed adjustable mechanism for maximum life
- Provides for fast and precise leveling
- Easy installation with low leveling torque required
- Rugged spherical seat version as standard for extreme torsional strength, even on uneven floors or rough machine feet
- Provides excellent vibration isolation in combination with our well-known AirLoc Isolation Pads



| | Article No. | Load lbf | H mm | L mm | B mm | d ₁ mm | Leveling mm | Torque lb-ft |
|----------------|-------------|----------|------|------|------|-------------------|-------------|--------------|
| bolt-on | | | | | | | | |
| 505.1-VRKC/716 | 1.36505.56 | 5500 | 78 | | | M12 | | |
| 505.1-VRKC/902 | 1.36505.59 | 13000 | 65 | 130 | 105 | M16 | +/- 3 | 30 |
| 505.1-VRKC/915 | 1.36505.65 | 13000 | 78 | | | | | |
| 515.1-VRKC/716 | 1.36515.56 | 10000 | 84 | | | M16 | | |
| 515.1-VRKC/902 | 1.36515.59 | 34000 | 71 | 160 | 140 | M20 | +/- 5 | 54 |
| 515.1-VRKC/915 | 1.36515.65 | 34000 | 84 | | | | | |

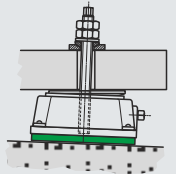

| | Article No. | Load lbf | H mm | L mm | B mm | d ₁ mm | Leveling mm | Torque lb-ft |
|---------------------|-------------|----------|------|------|------|-------------------|-------------|--------------|
| bolt-through | | | | | | | | |
| 505.2-VRKC/716 | 1.37505.56 | 5500 | 78 | | | | | |
| 505.2-VRKC/902 | 1.37505.59 | 13000 | 65 | 130 | 105 | 18 | +/- 3 | 30 |
| 505.2-VRKC/915 | 1.37505.65 | 13000 | 78 | | | | | |
| 515.2-VRKC/716 | 1.37515.56 | 10000 | 84 | | | | | |
| 515.2-VRKC/902 | 1.37515.59 | 34000 | 71 | 160 | 140 | 21 | +/- 5 | 54 |
| 515.2-VRKC/915 | 1.37515.65 | 34000 | 84 | | | | | |

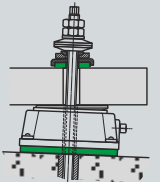

| | Article No. | Load lbf | H mm | L mm | B mm | d ₁ mm | Leveling mm | Torque lb-ft |
|--------------------|-------------|----------|------|------|------|-------------------|-------------|--------------|
| rigid clamp | | | | | | | | |
| 505-KSKC | 1.47505 | 13000 | 63 | 130 | 105 | 18 | +/- 3 | 30 |
| 515-KSKC | 1.47515 | 34000 | 69 | 160 | 140 | 21 | +/- 5 | 54 |

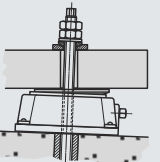

| | Article No. | Load lbf | H mm | L mm | B mm | d ₁ mm | Leveling mm | Torque lb-ft |
|-----------------|--------------|----------|------|------|------|-------------------|-------------|--------------|
| socket | | | | | | | | |
| 505.6-VRKCS/902 | 1.53505-6.59 | 13000 | 65 | 130 | 105 | - | +/- 3 | 30 |
| 505.6-VRKCS/915 | 1.53505-6.65 | 13000 | 78 | | | | | |
| 515.6-VRKCS/902 | 1.53515-6.59 | 34000 | 71 | 160 | 140 | - | +/- 5 | 54 |
| 515.6-VRKCS/915 | 1.53515-6.65 | 34000 | 84 | | | | | |

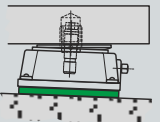

- Mounting system KaBloc**
- Only for 515-QFixx
 - Load up to 34000 lbf
 - Leveling +/- 5 mm
 - max. leveling torque 54 lb-ft
 - Subsequent anchoring if required

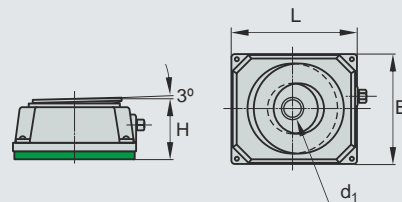

AirLoc Schrepfer AG

Industriestrasse 2, CH-8618 Oetwil am See
Telephone +41 44 929 77 00, Fax +41 44 929 7710
www.airloc-schrepfer.com, info@airloc-schrepfer.com

Worldwide Distributors

Please visit us in the Internet at www.airloc-schrepfer.com for details about our worldwide distributors.

All information and specifications are true and correct to the best of our knowledge; they do not represent an assurance of properties and do not release users from examination on their own, also with reference to the trademark rights of third parties. Technical revisions are subject to change without prior notice.